



LED Tennis Court Photometric Design:

AF33XCOMPT8X825750

Operator ST
Telephone
Fax
e-Mail

Exterior Scene 1 / Light scene 29 / Planning data

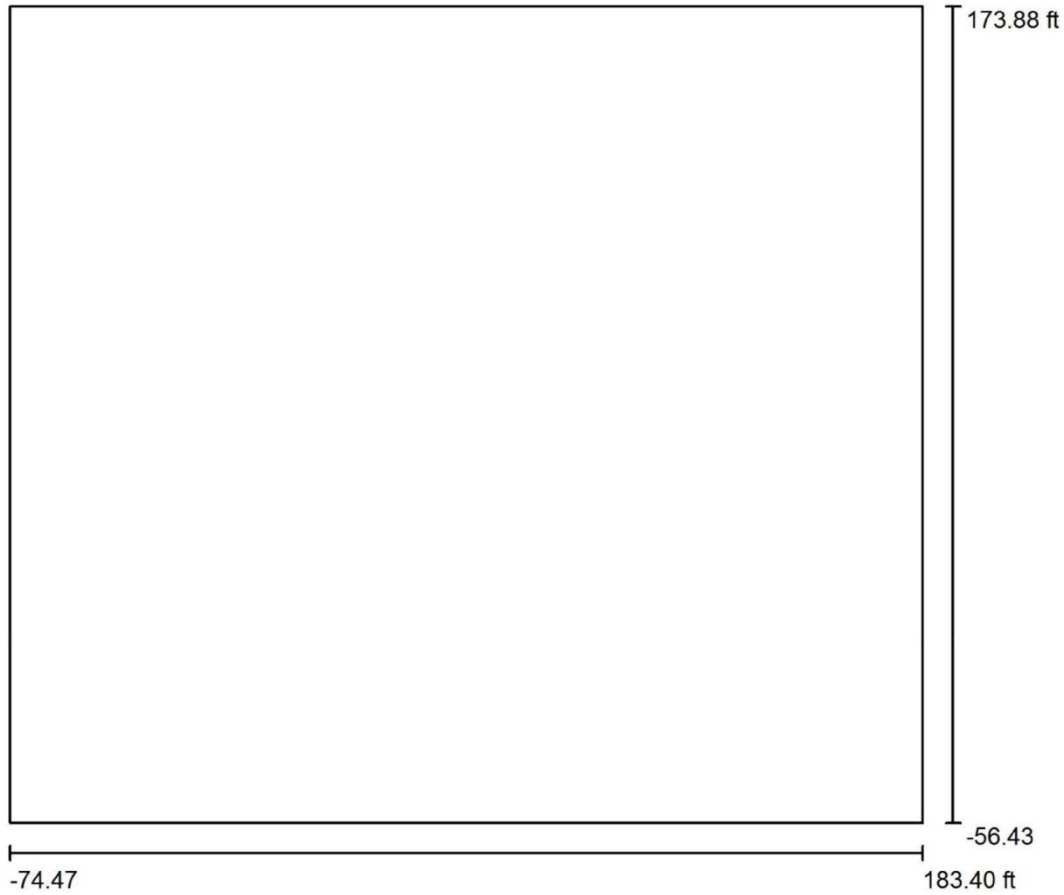

Maintenance factor: 0.80, ULR (Upward Light Ratio): 0.5%

Scale 1:651

Luminaire Parts List

No.	Pieces	Designation (Correction Factor)	(Luminaire) [lm]	(Lamps) [lm]	P [W]
1	8	769w LED Sport Light - 60D	92751	92750	811.7
Total:			742012	Total: 742000	6493.6

Operator ST
Telephone
Fax
e-Mail

Exterior Scene 1 / Light scene 29 / False Color Rendering

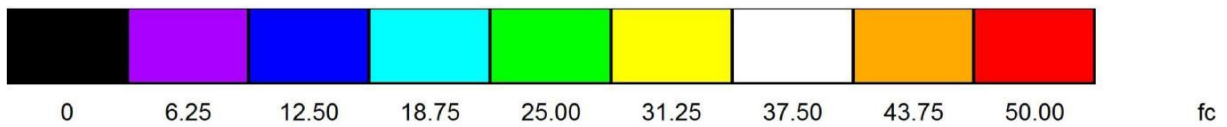
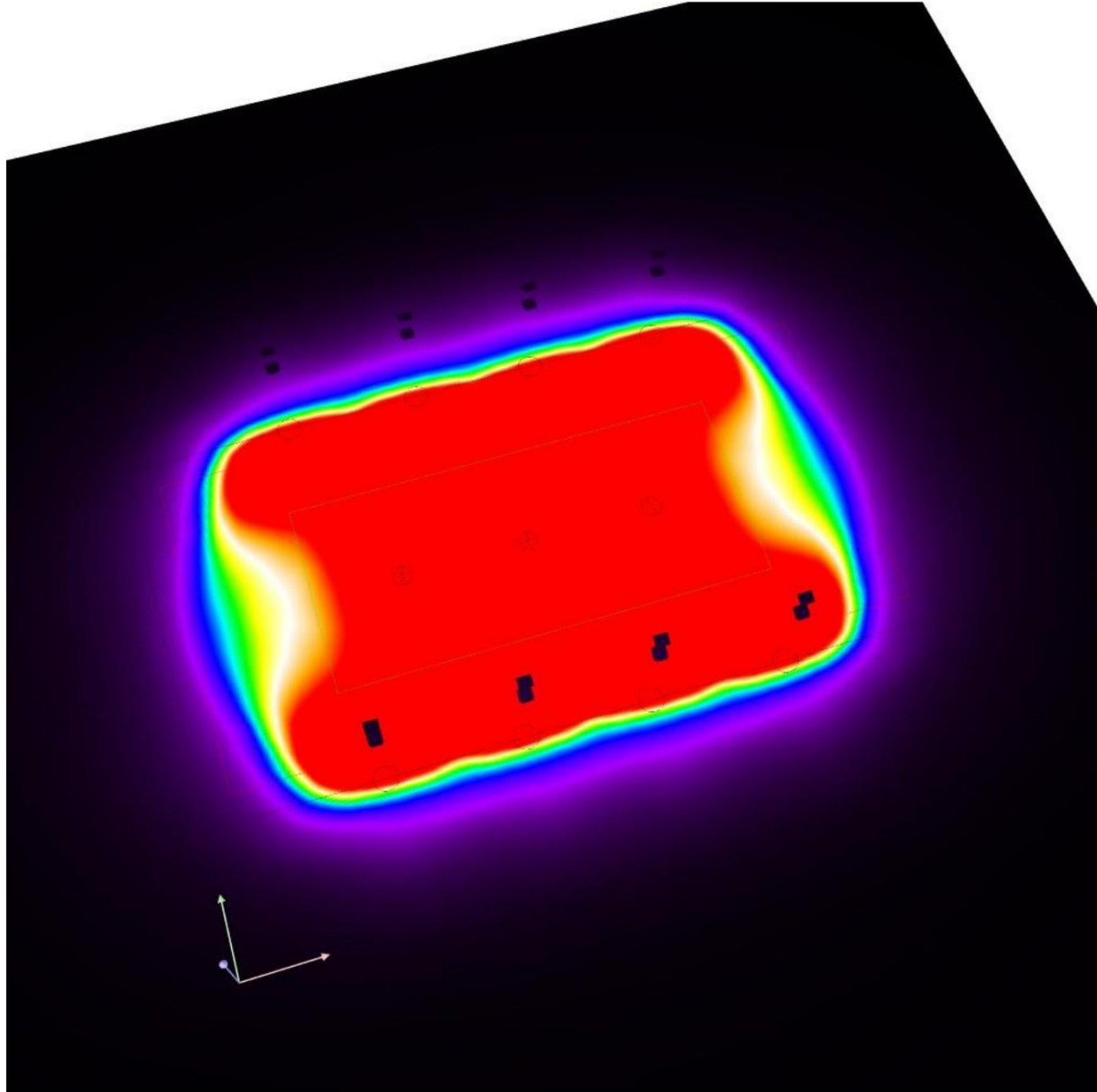

Operator ST
 Telephone
 Fax
 e-Mail

Exterior Scene 1 / Light scene 29 / Light Trespass / Value Chart (E, Perpendicular)

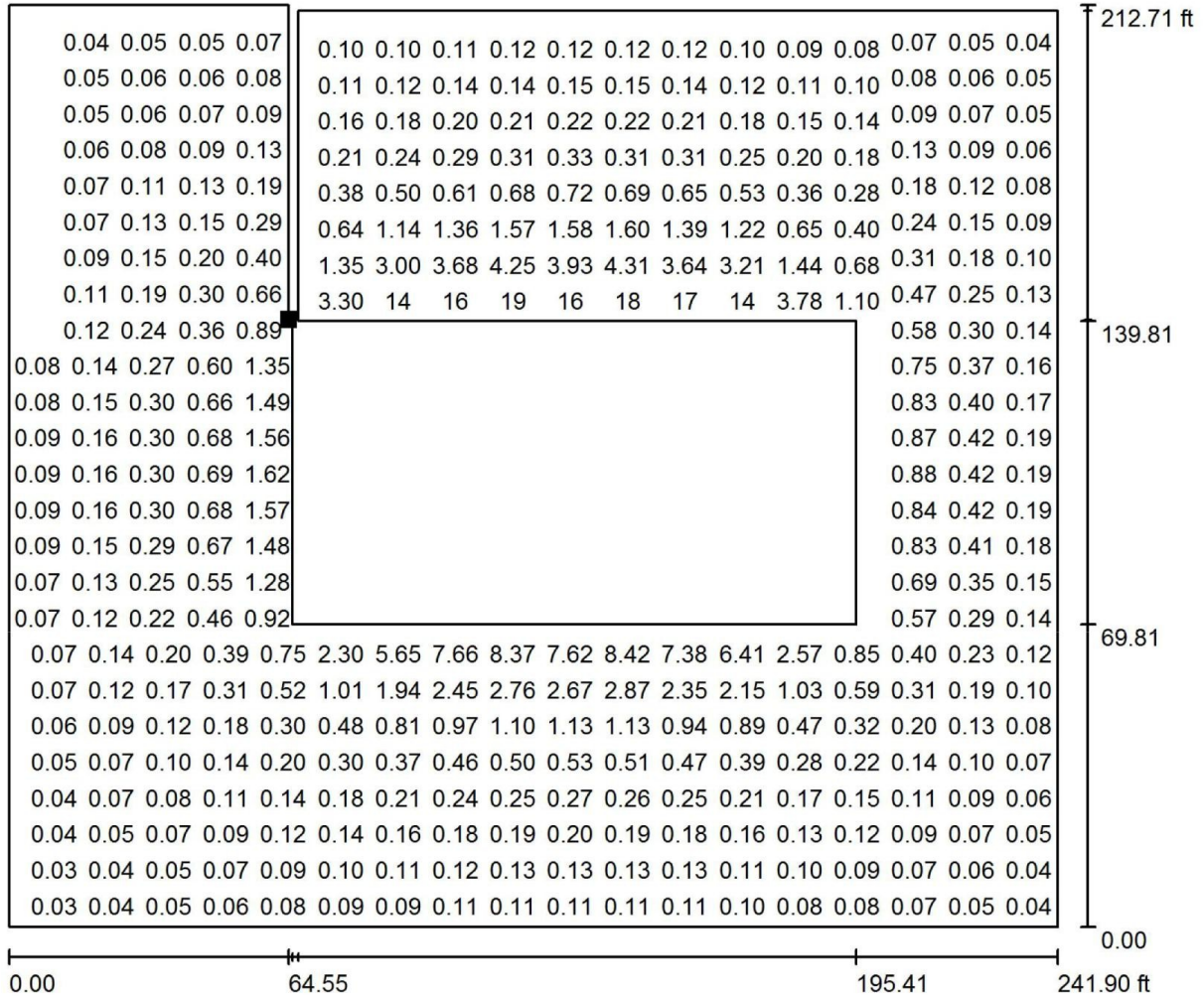

Values in Footcandles, Scale 1 : 528

Not all calculated values could be displayed.

Position of surface in external scene:
 Marked point:
 (-0.916 ft, 95.305 ft, 0.000 ft)

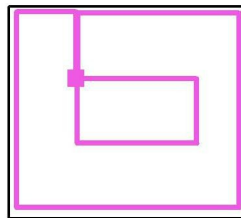

Grid: 128 x 128 Points

E_{av} [fc]
 1.35

E_{min} [fc]
 0.03

E_{max} [fc]
 69

u0
 0.022

E_{min} / E_{max}
 0.000

Operator ST
 Telephone
 Fax
 e-Mail

Exterior Scene 1 / Light scene 29 / Tennis 1 Calculation Grid (PA) / Value Chart (E, Horizontal)

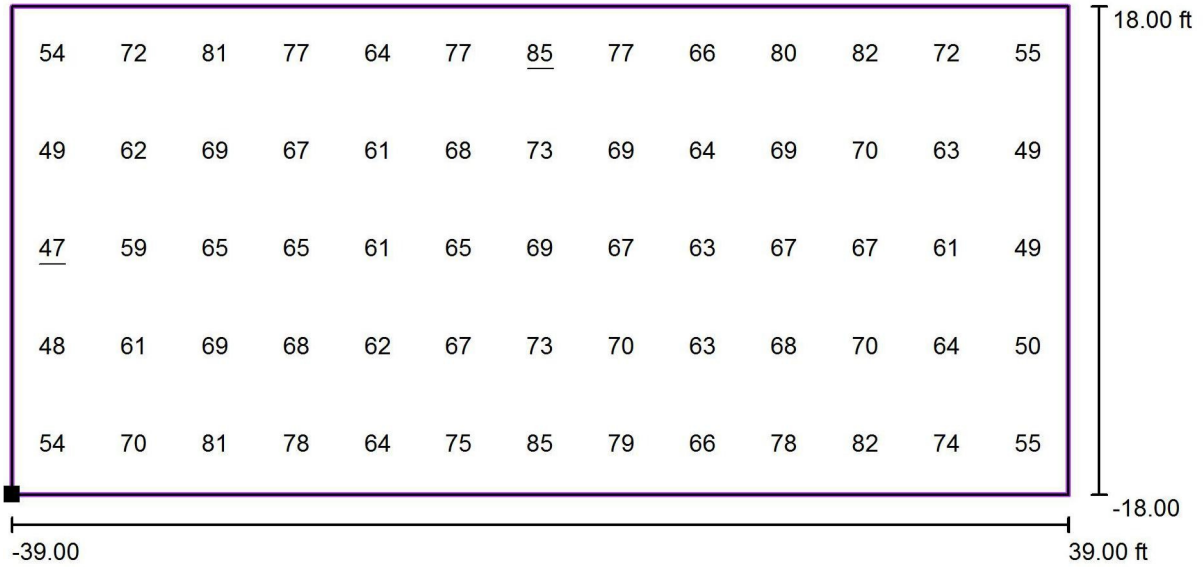

Values in Footcandles, Scale 1 : 170

Position of surface in external scene: Marked point: (25.960 ft, 42.039 ft, 0.000 ft)

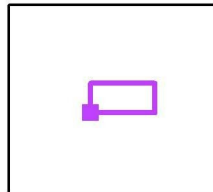

Grid: 13 x 5 Points

E_{av} [fc]	E_{min} [fc]	E_{max} [fc]	u_0	E_{min} / E_{max}
67	47	85	0.71	0.55

Operator ST
 Telephone
 Fax
 e-Mail

Exterior Scene 1 / Light scene 29 / Tennis 1 Calculation Grid (PA) / Value Chart (E, Horizontal)

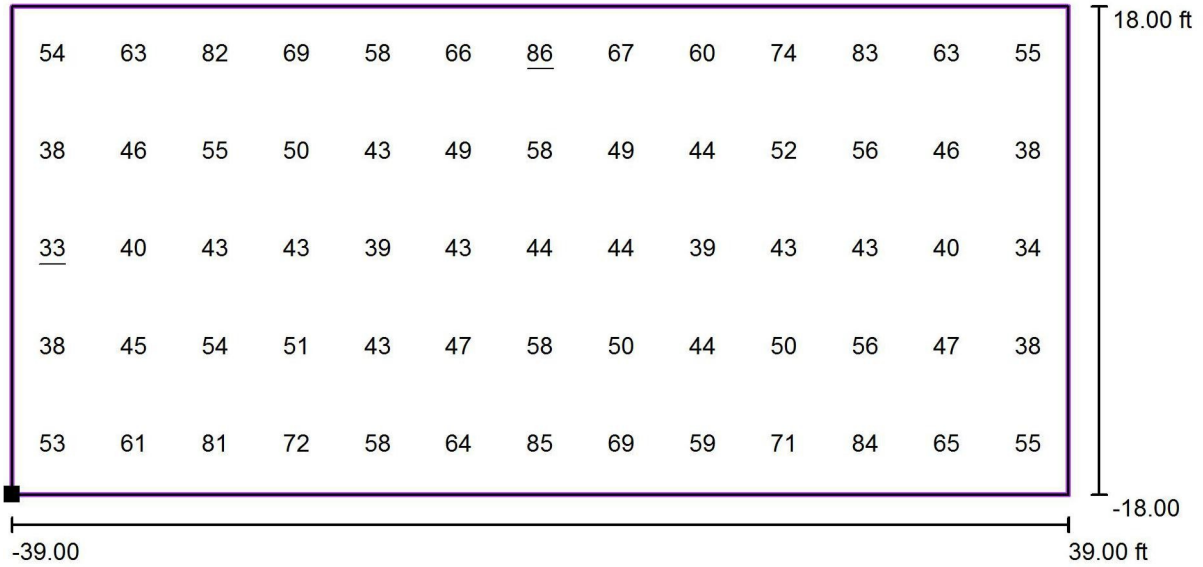

Values in Footcandles, Scale 1 : 170

Position of surface in external scene: Marked point: (25.960 ft, 42.039 ft, 5.000 ft)

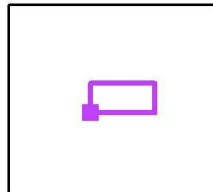

Grid: 13 x 5 Points

E_{av} [fc]	E_{min} [fc]	E_{max} [fc]	u_0	E_{min} / E_{max}
54	33	86	0.62	0.39

Tennis Layout: AF33XCOMPT8X825750

Operator ST
Telephone
Fax
e-Mail

Exterior Scene 1 / Light scene 29 / Tennis 1 Calculation Grid (PA) / Value Chart (E, Horizontal)

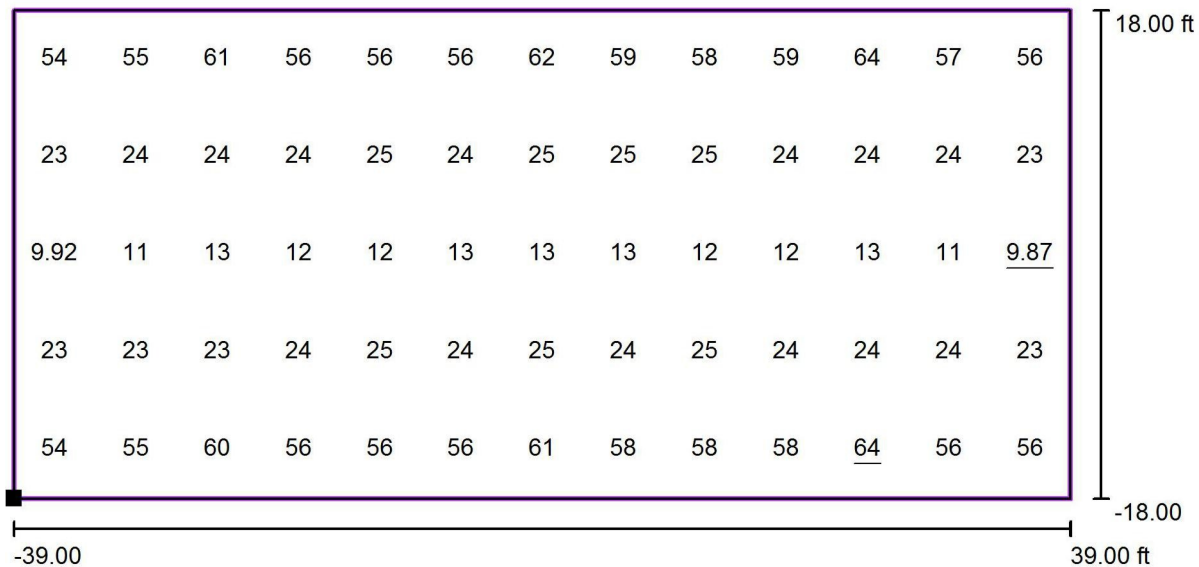

Values in Footcandles, Scale
1 : 170

Position of surface in external scene: Marked point: (25.960 ft, 42.039 ft, 10.000 ft)

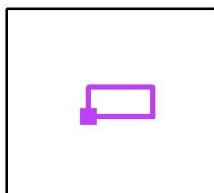

Grid: 13 x 5 Points

E_{av} [fc]
35

E_{min} [fc]
9.87

E_{max} [fc]
64

u_0
0.28

E_{min} / E_{max}
0.15