



AccessFixtures

High-Performance Lighting Solutions

SMOL Low Profile Bollards

106,000 Hours



AF33XNB1C3 - Round Low Profile Pathway Bollard



AF33XNB2C3 - Square Low Profile Pathway Bollard

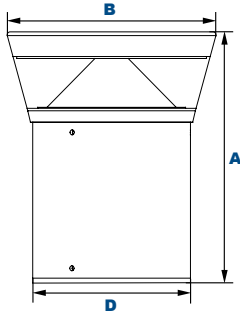

Dimensions

Width (B)	9 1/4" (234mm)
Diameter (D)	7" (180mm)
Height (A)	10" (254mm)

The Access Fixtures SMOL LED Low Profile Bollard Lights with UV-stabilized polycarbonate lenses and sealed optical compartments are designed to replace incandescent and halogen pathway lighting.

Specifications and Features:

Housing:

Extruded Aluminum Housing with Flush Mounting Base & Vandal-Resistant Screws, Flat Top, Internal Driver Tray for Easy Maintenance.

Listing & Ratings:

CSA: Listed for Wet Locations, ANSI/UL 1598, 8750
IP66 Sealed LED Compartment.

Finish:

Textured Architectural Bronze or Black Powdercoat Finish Over a Chromate Conversion Coating. Custom Colors Available Upon Request.

Reflector:

Reflective White UV-Stabilized Polycarbonate Cone Reflector

Lens:

Clear UV-Stabilized Polycarbonate Vandal-Resistant Lens

Mounting Options:

Mounting Kit with 8" Anchor Bolts, Included.

Wattage:

COB: 20w, System: 20w; (70w HID Equivalent)

Driver:

Electronic Driver, 120-277V, 50/60Hz or 347V, 50/60Hz; Less Than 20% THD and PF>0.90. Standard Internal Surge Protection 2kV. 0-10V Dimming Standard for a Dimming Range of 100% to 10%; Dimming Source Current is 150 Microamps.

Warranty:

5-Year Warranty for -20°C to +40°C Environment.

See Page 2 for Projected Lumen Maintenance Table.

Order Information Example:

AF33XNB1C34X5U41KZ10SF

Model	Wattage	Driver	CCT	Color	Height	Options
AF33XNB1C3=Round Low Profile Pathway Bollard AF33XNB2C3=Square Low Profile Pathway Bollard	4X5=20w	U=120-277V C=347V	41K=4100K	Z=Bronze B=Black C=Custom (Consult Factory)	10=10" C=Custom*	SF=Single Fuse (120-277V Only) DF=Double Fuse (120-277V Only) SP=Surge Protection

Project Information:

Project Name: _____ Fixture Type: _____

Complete Catalog #: _____ Date: _____

Comments: _____

Certification & Listings:





AccessFixtures

High-Performance Lighting Solutions

Accessories & Replacement Parts:

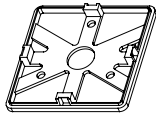
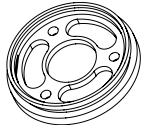
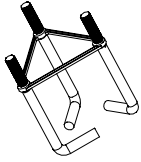

AF33XBOLAN AF33XBORBASE AF33XBOSBASE

Mounting Accessories (Order Separately, Field Installed)

AF33XBOLAN4 Mounting Kit, Includes Bracket & Three (3) 4" AnchorBolts

AF33XBOLAN8 Mounting Kit, Includes Bracket & Three (3) 8" AnchorBolts

AF33XBOLAN12 Mounting Kit, Includes Bracket & Three (3) 12" AnchorBolts

AF33XBOLAN15 Mounting Kit, Includes Bracket & Three (3) 15" AnchorBolts

Replacement Parts (Order Separately, Field Installed)

AF33XBORBASE* Die Cast Base Plate with Powdercoat Finish Over a Chromate Conversion Coating. Fits NB1.

AF33XBOSBASE* Die Cast Base Plate with Powdercoat Finish Over a Chromate Conversion Coating. Fits NB2.

*Specify Color: Z=Bronze, B=Black, C=Custom (Consult Factory)

Photometric Data

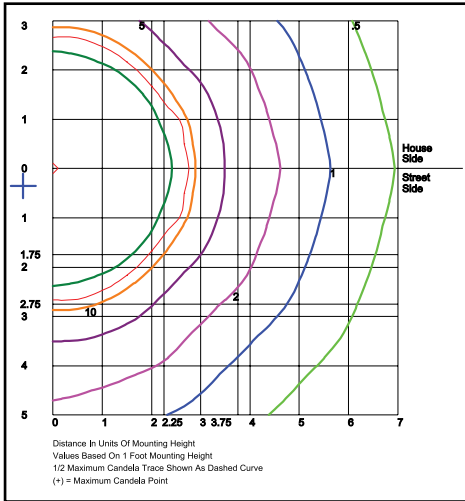

AF33XNB1C34X5U41K
Grid in feet, Mounting Height=1ft.

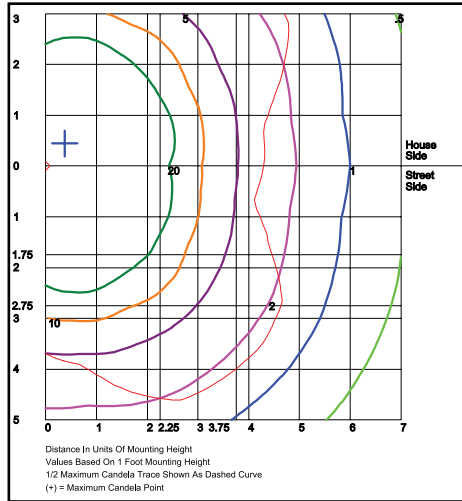

AF33XNB2C34X5U41K
Grid in feet, Mounting Height=1ft.

Photometric Performance

LED COB Watts	Drive Current (mA)	Input Watts	Bollards	4100 CCT 80 CRI				
				Lumens	LPW	B	U	G
LED 20w	350	20	AF33XNB1C3 (Round Low Profile Pathway Bollards)	2,282	87	1	0	1
			AF33XNB2C3 (Square Low Profile Pathway Bollards)	2,409	91	1	0	1

Projected Lumen Maintenance

Data shown for 4100 CCT			Compare to MH			
TM-21-11	Input Watts	Initial	25,000 Hrs	50,000 Hrs	100,000 Hrs	Calculated L70@ 25°C
AF33XNB1C3 L70 Lumen Maintenance @ 25°C / 77°F	20	1.00	0.93	0.86	0.72	106,000
AF33XNB2C3 L70 Lumen Maintenance @ 25°C / 77°F	20	1.00	0.93	0.86	0.72	106,000
TM-21-11	Input Watts	Initial	25,000 Hrs	50,000 Hrs	100,000 Hrs	Calculated L70@ 50°C
AF33XNB1C3 L70 Lumen Maintenance @ 50°C / 122°F	20	1.00	0.91	0.83	0.66	88,000
AF33XNB2C3 L70 Lumen Maintenance @ 50°C / 122°F	20	1.00	0.91	0.83	0.66	88,000
TM-21-11	Input Watts	Initial	25,000 Hrs	50,000 Hrs	100,000 Hrs	Calculated L80@ 40°C
AF33XNB1C3 L80 Lumen Maintenance @ 40°C / 104°F	20	1.00	0.92	0.84	0.67	61,000
AF33XNB2C3 L80 Lumen Maintenance @ 40°C / 104°F	20	1.00	0.92	0.84	0.67	61,000

NOTES:

1. Projected per IESNA TM-21-11. Data references the extrapolated performance projections for the 350mA base model in a 25°C ambient, based on 10,000 hours of LED testing per IESNA LM-80-08.
2. Compare to MH box indicates suggested Light Loss Factor (LLF) to be used when comparing to Metal Halide (MH) systems.